

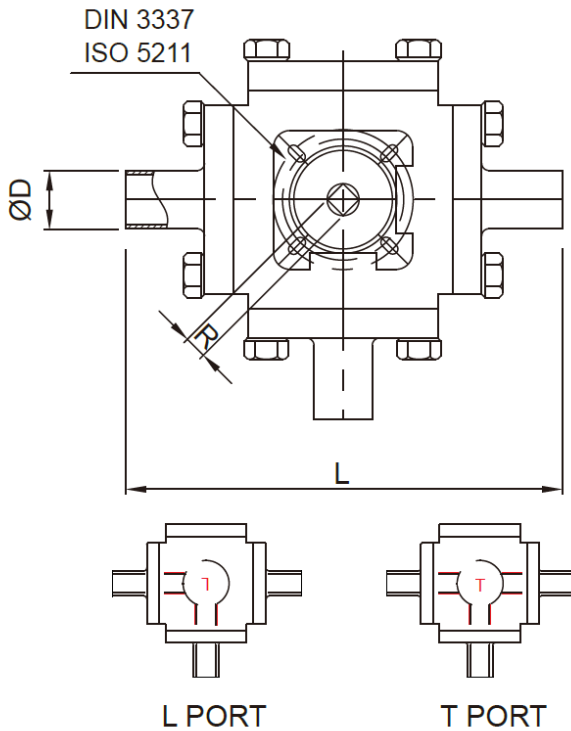

Berkeley Stainless Fittings Limited

3 Way Sanitary Ball Valve - L/T Port



SANITARY BALL VALVE - 3 WAY "L" & "T" PORT 316

	1/2"	3/4"	1"	1.5"	2"	2.5"	3"
L Port Code	2111200	2111205	2111210	2111215	2111220	2111225	2111230
T Port Code	2111300	2111305	2111310	2111315	2111320	2111325	2111330
ISO 5211	F03	F03	F04	F05	F05	F07	F10
Ød	12.7	19.05	25.4	38.1	50.8	63.5	76.2
R	9	9	11	14	14	17	22
L	118	127	152.6	175	190	228	260.6
Torque N-M	10.5 N-M	10.5 N-M	15 N-M	32 N-M	50 N-M	125 N-M	180 N-M

*TORQUE DOES NOT INCLUDE SAFETY & IS BASED ON WATER.

3 WAY VALVE INFORMATION:

- BODY & WETTED PARTS GRADE 316 STAINLESS STEEL.
- STOCKED FROM 1/2" OD - 3" OD.
- 'L' & 'T' CONFIGURATION.
- WELD ENDS AVAILABLE EX-STOCK - ALTERNATIVE ENDS OF YOUR CHOICE CAN BE SUPPLIED.
- HYGIENIC STANDARD.
- SUITABLE FOR USE IN VACUUM ENVIRONMENT - MAX 3 TORRS
- FULL BORE DESIGN.
- PTFE CAVITY SEAT - CREVICE FREE.
- 10 BAR MAX WORKING PRESSURE.
- STANDARD ISO MOUNTING PAD.
- FULL ACTUATION PACKAGE AVAILABLE FROM STOCK.